

| Parts List | | | | | | |
|------------|-------|-----------|-----------------------------------|-----|---------------------------------|----------|
| Ref | Class | Part | Description | Qty | Comment | Footnote |
| 1 | | 862346T | BRACKET, Front Lifting Eye | 1 | | |
| 2 | 10 | 40108 20 | SCREW, (M10 x 20) | 2 | | |
| 3 | 84 | 865457T04 | HARNESS, Engine | 1 | (Mechanical Throttle and Shift) | |
| 3 | 84 | 865653T02 | HARNESS, Engine | 1 | (Digital Throttle and Shift) | |
| NS | 84 | 865769T01 | HARNESS, Transom | 1 | (Mechanical Throttle and Shift) | |
| NS | 84 | 865676T01 | HARNESS, Transom | 1 | (Digital Throttle and Shift) | |
| 4 | | 26079A 2 | PLATE KIT, Wire Harness Mount, F | 1 | | |
| 5 | 10 | 15001 | SCREW, (#8-16 x .875) | 4 | | |
| 6 | | 862347T | BRACKET, Rear Lifting Eye | 1 | | |
| 7 | 10 | 40108 20 | SCREW, (M10 x 20) | 3 | | |
| 8 | | 816492A15 | ALARM KIT | 1 | | |
| 9 | | 891735 | CAP, Weather Proof, 10 Pin Transc | 1 | | |

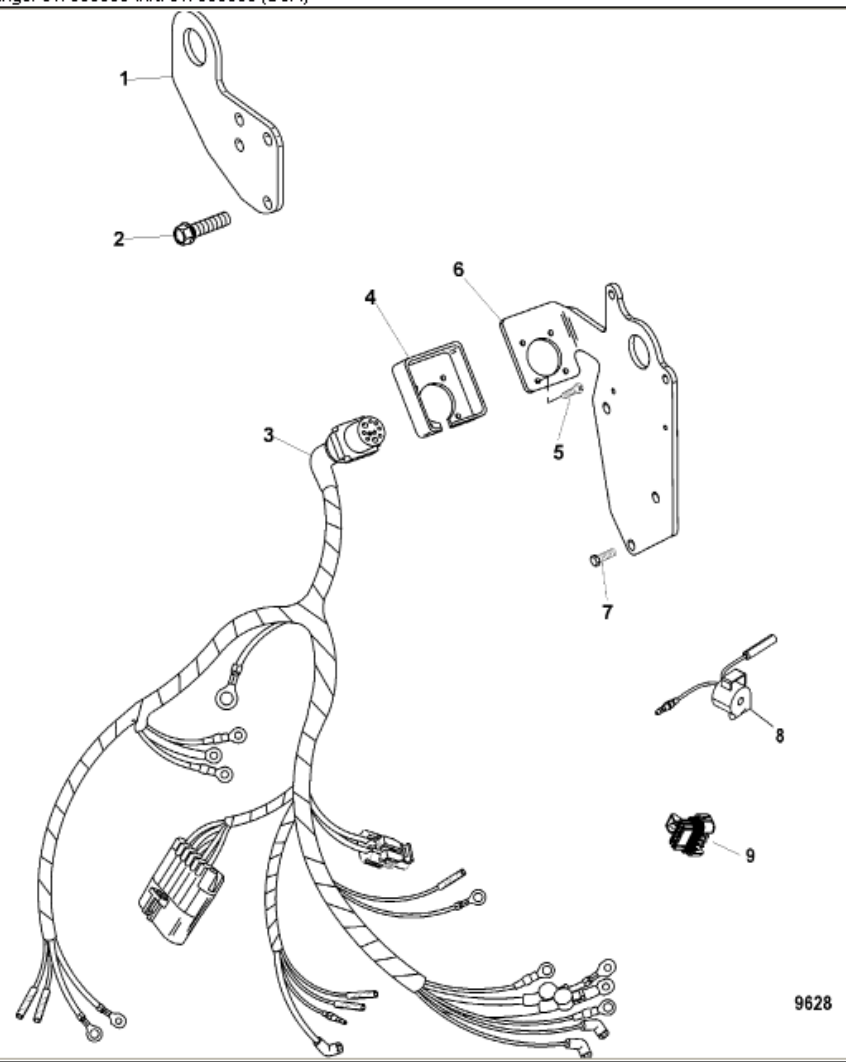

9628